

HERCUWALL™

The panelized shell and demising wall system.

Product Overview

Bring a faster, better building strategy to the table. Fabricated off-site and delivered ready to assemble, HercuWall™ is the panelized shell and demising wall system that eliminates costly and time-consuming steps. HercuWall is three times stronger than traditional wood framing and light enough to be carried by one installer. This results in a stronger, more energy-efficient and sustainable building solution.

Features & Benefits

- Faster construction that saves 2-3 months on projects
- Requires less labor compared to traditional construction methods
- Lowers construction costs while maintaining high quality
- Promotes green construction with energy-efficient and eco-friendly materials
- Enhances soundproofing for a more comfortable environment

Want to Learn More?

For more information, contact Mike Barker, VP of Strategic Sales for Tremco CPG Inc. at mbarker@tremcoinc.com.

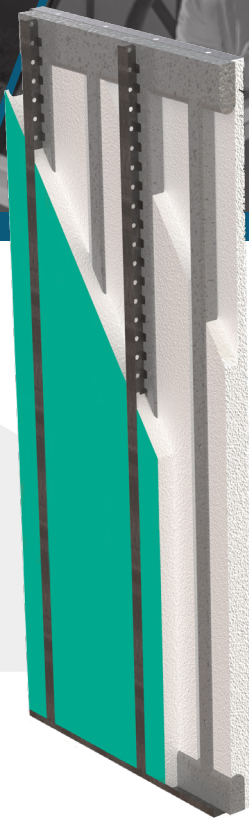

Nudura | 3735 Green Road | Beachwood, Oh 44124 | nudura.com

Tremco Construction Products Group (CPG) brings together Tremco CPG Inc. and its Dryvit and Nudura brands; Willseal; Prebuck LLC; Tremco Barrier Solutions, Inc.; Weatherproofing Technologies, Inc. and its Pure Air Control Services and Canam Building Envelope Specialists offerings; and Weatherproofing Technologies Canada, Inc.



Use of the ® symbol indicates registration with the US Patent & Trademark Office and the Canadian Intellectual Property Office.
© Tremco CPG Inc. 2025

L-0086/03.2025

tremcocpg.com